

ACCESSORI OPZIONALI | OPTIONAL ACCESSORIES

GTA17	Set di 4 gambe con ruote e freno da Ø 80mm	Leg with casters Ø 80 mm
GFA03	Versione opposta	Opposite version
PRF	Plani a rulli in uscita	Out-feed free roller conveyors
GTA-SC	Colore speciale	Special color
1-PH	Versione monofase	Single-phase version

CARATTERISTICHE TECNICHE | TECHNICAL DATA

	GF 056	GF 056 P
Capacità produttiva Productivity	600/800 scatole-boxes/h	600/800 scatole-boxes/h
Consumo aria compressa Air consumption	2,1 nl. per ciclo a 6 bar 2,1 nl. per production cycle at 6 bar	6,0 nl. per ciclo a 6 bar 6,0 nl. per production cycle at 6 bar

Dati indicativi in funzione delle caratteristiche scatole | Indicative data depending on the box configuration

DIMENSIONI | DIMENSIONS

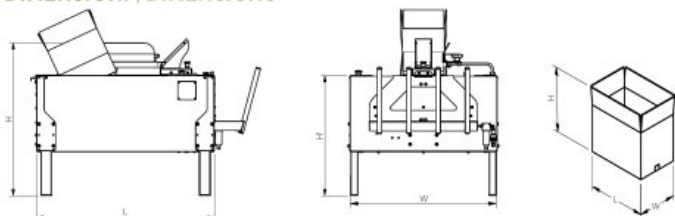

GF 056	
L	Min 140 / Max 650 mm
W	Min 100 / Max 510 mm
H	Min 100 / Max 510 mm

GF 056 XL	
L	Min 140 / Max 950 mm
W	Min 100 / Max 510 mm
H	Min 100 / Max 510 mm

	L	H	H'	W	Kg
GF 056	970 mm	834 mm	655 mm	807 mm	102
GF 056 XL	1270 mm	834 mm	655 mm	807 mm	120

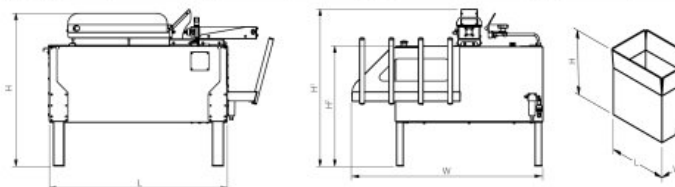

GF 056 P	
L	Min 140 / Max 500 mm
W	Min 100 / Max 510 mm
H	Min 100 / Max 510 mm

GF 056 P XL	
L	Min 140 / Max 800 mm
W	Min 100 / Max 510 mm
H	Min 100 / Max 510 mm

	L	H	H'	H''	W	Kg
GF 056 P	970 mm	834 mm	856 mm	655 mm	1042 mm	115
GF 056 P XL	1270 mm	834 mm	856 mm	655 mm	1042 mm	125

Le caratteristiche tecniche possono essere soggette a variazioni senza preavviso | Specifications subject to change without notice

Altre lingue disponibili | Other languages available: www.eenamarchetti.it |



PACBRO S.r.l.
Via Don Milani, 1 | 20025 Legnano (MI), Italy | Tel. +39 0331 599518 | Fax +39 0331 545291

www.eenamarchetti.it | info@elenamarchetti.it | [elenamarchettipackagingmachines](https://www.facebook.com/elenamarchetti)

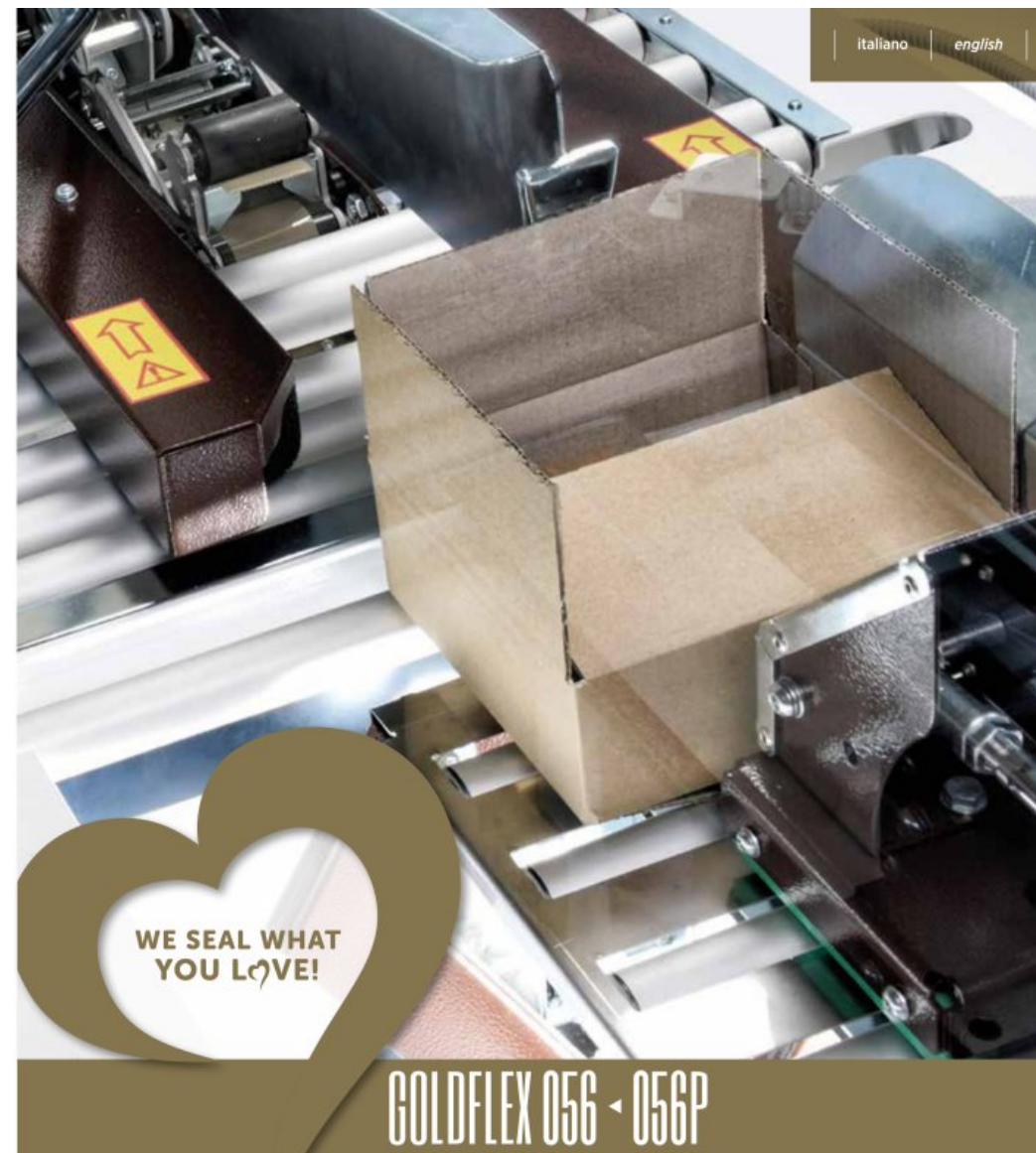

GOLDFLEX 056 - 056P

**FORMATORI SEMI-AUTOMATICI
REGOLAZIONE MANUALE SUI DIVERSI FORMATI SCATOLA**
**SEMI-AUTOMATIC CASE ERECTORS
MANUALLY ADJUSTABLE ON DIFFERENT BOX SIZES**



PACKAGING MACHINES

